

FEMMINA GIREVOLE O’RING FILETTO METRICO CONO 24° - SERIE PESANTE
O’RING METRIC SWIVEL FEMALE 24° CONE - HEAVY TYPE
- DKOS -

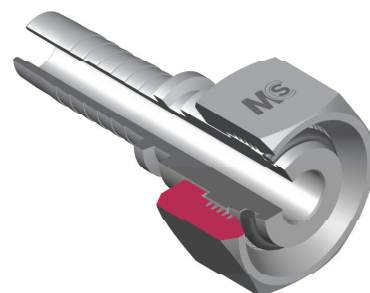
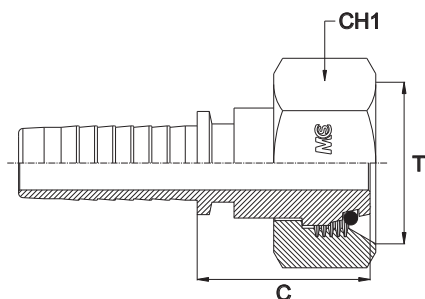

Bar W.P.	Codice Part Number	Filetto Thread	Ø Int. Tubo Inch. Hose I.D.	DIN 24°	C Cut - Off	CH1
420	ORMSFH0603	14x1,5	3/16"	06S	22,5	17
450	ORMSFH0604	14x1,5	1/4"	06S	22,5	17
420	ORMSFH0803	16x1,5	3/16"	08S	22,5	19
450	ORMSFH0804	16x1,5	1/4"	08S	22,5	19
350	ORMSFH0805	16x1,5	5/16"	08S	26,0	19
450	ORMSFH0806	16x1,5	3/8"	08S	26,0	19
	ORMSFH1004	18x1,5	1/4"	10S	26,0	22
350	ORMSFH1005	18x1,5	5/16"	10S	25,5	22
450	ORMSFH1006	18x1,5	3/8"	10S	26,0	22
	ORMSFH1204	20x1,5	1/4"	12S	26,0	24
350	ORMSFH1205	20x1,5	5/16"	12S	26,0	24
450	ORMSFH1206	20x1,5	3/8"	12S	26,0	24
420	ORMSFH1208	20x1,5	1/2"	12S	27,0	24
350	ORMSFH1405	22x1,5	5/16"	14S	27,0	27
450	ORMSFH1406	22x1,5	3/8"	14S	26,5	27
420	ORMSFH1408	22x1,5	1/2"	14S	26,0	27
	ORMSFH1606	24x1,5	3/8"	16S	32,0	30
	ORMSFH1608	24x1,5	1/2"	16S	32,0	30
350	ORMSFH1610	24x1,5	5/8"	16S	36,0	30
	ORMSFH2008	30x2	1/2"	20S	36,0	36
	ORMSFH2010	30x2	5/8"	20S	36,0	36
	ORMSFH2012	30x2	3/4"	20S	36,5	36
	ORMSFH2510	36x2	5/8"	25S	36,5	46
280	ORMSFH2512	36x2	3/4"	25S	36,5	46
	ORMSFH2516	36x2	1"	25S	37,0	46
	ORMSFH3012	42x2	3/4"	30S	36,5	50
	ORMSFH3016	42x2	1"	30S	37,0	50
210	ORMSFH3020*	42x2	1" 1/4	30S	36,5	50
	ORMSFH3816	52x2	1"	38S	37,0	60
185	ORMSFH3820	52x2	1" 1/4	38S	42,5	60
	ORMSFH3824	52x2	1" 1/2	38S	42,5	60
	ORMSFH5024	68x2	1" 1/2	50S	37,0	80

* Dado Pressato

* Crimping Nut